

SteelFlex

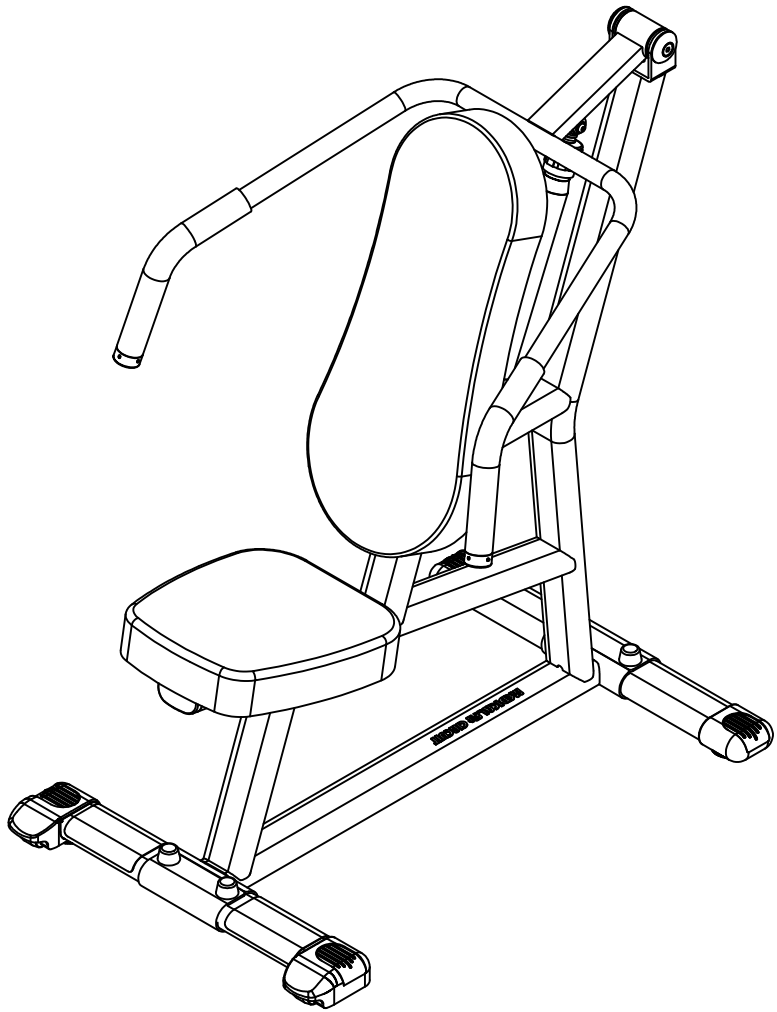

The Surgeon General
has determined that lack
of physical activity is
detrimental to your health.™

Trademark of United States Fitness Products Council

THERE IS A RISK ASSUMED BY INDIVIDUALS WHO USE THIS TYPE OF EQUIPMENT. TO MINIMIZE RISK, YOU MUST FOLLOW THESE RULES:

1. Inspect equipment before each workout. Check that all nuts, bolts, screws and pop pins are in place and fully tightened. Also, before use, check cylinders for leaking. Replace all worn parts immediately. Never use machine if any parts are damaged or missing. Failure to follow these rules may result in serious injury.
2. Keep clear of the cylinder and all moving parts when the machine is in use.
3. Exercise with care. Perform your exercises at a smooth moderate pace; never perform jerky or uncoordinated movements that may cause injury.
4. It is recommended that you should workout with a training partner.
5. Do not allow children or minors to play on or around this equipment.
6. If unsure of proper use of equipment, call your local distributor.
7. **WARNING:** Consult your physician before starting your exercise program. For your own safety do not begin any exercise program without proper instruction.

CSP-900 OWNER'S MANUAL

CSP-900 ASSEMBLY INSTRUCTIONS

HARDWARE ILLUSTRATION

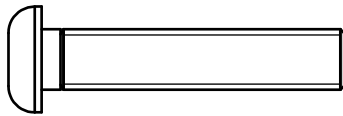
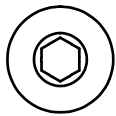

(A1)ROUND INNER HEX SCREW M8X40L PARTIAL QTY.2

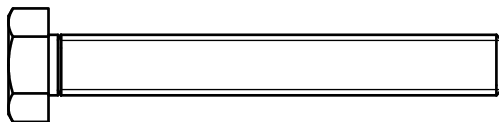
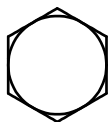

(A2)HEX BOLT M8X60L PARTIAL QTY.4

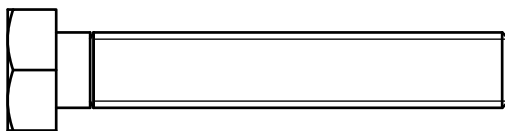
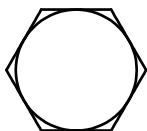

(A3)HEX BOLT M10X60L PARTIAL QTY.4



(A4)BOLT CAP(9212-024) QTY.4

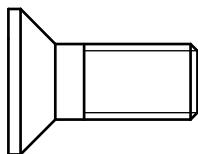
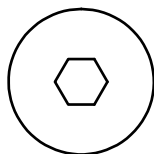

(A5)M10X25L SOCKER FLAT SCREW QTY.2



CSP-900 ASSEMBLY INSTRUCTIONS

HARDWARE ILLUSTRATION

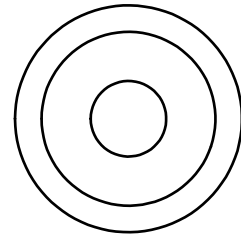
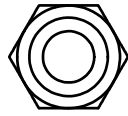
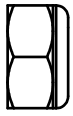

(B1) M8 NYLON LOCK NUT QTY.2 (C4) 3/8" ROUND END CAP WASHER QTY.4

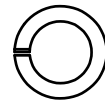
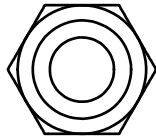
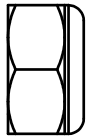

(B2) M10 NYLON LOCK NUT QTY.4 (C5) M8 SPRING WASHER QTY.4

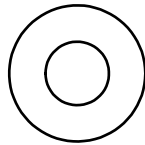

(C1) M8 (I.D.) FLAT WASHER Ø18 QTY.4

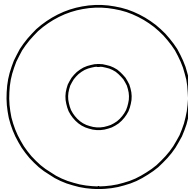

(C2) M8 (I.D.) FLAT WASHER Ø24 QTY.4

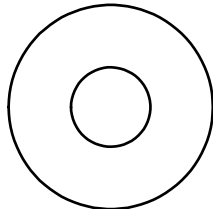

(C3) M10 (I.D.) FLAT WASHER Ø27 QTY.4



CSP-900 ASSEMBLY INSTRUCTIONS

HARDWARE ILLUSTRATION

(D1)Ø50X10 END COVER(8130-131)	-----	[2PCS]
(D2)40X80 END CAP(9211-113)	-----	[2PCS]
(D3)Ø60X42H DECK BUFFER(9214-037)	-----	[2PCS]
(D4)40X80 ROUND END COVER(9261-070)	-----	[2PCS]
(D5)40X80 FOOT CAP(9261-071)	-----	[1PCS]
(D6)40X80 FOOT CAP(9261-072)	-----	[1PCS]
(D7)95X140L RUBBER PAD(9630-003)	-----	[2PCS]

D1.

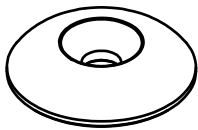

D2.

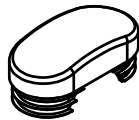

D3.

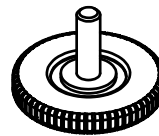

D4.

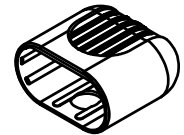

D5.

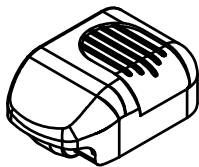

D6.

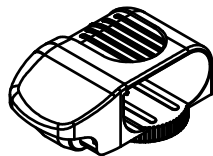

D7.

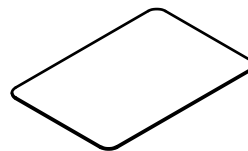

PARTS ILLUSTRATION SHEET

A[1SET]

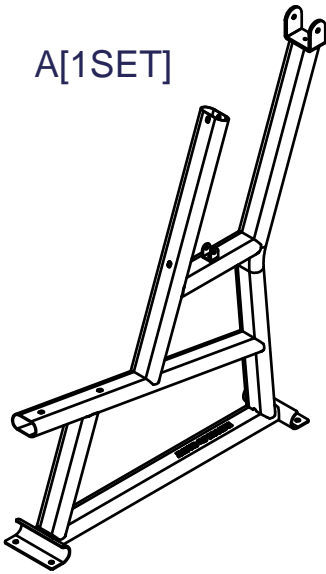

B[1SET]

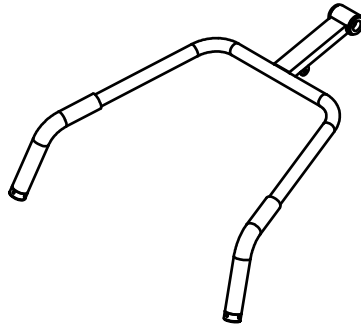

C[1PCS]

5584-K007 40X80X2tX600L

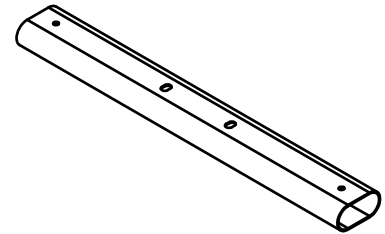

D[1PCS]

5584-K008 40X80X2tX600L

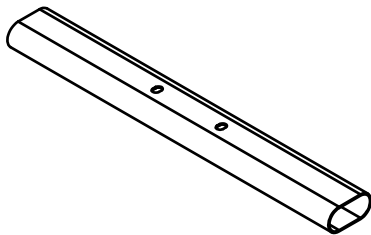

E[1SET]

8220-148 Ø25.4X73.5L

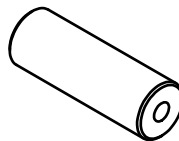

F[2PCS]

8386-101

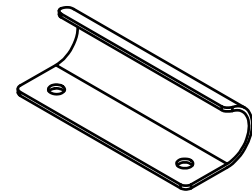

G[1PCS]

8830-017

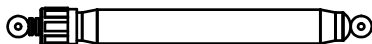

H[1PCS]

9121-064

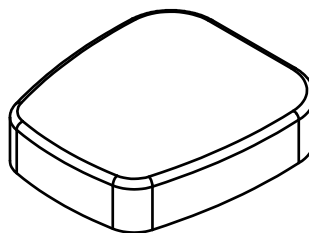

I[1PCS]

9111-065

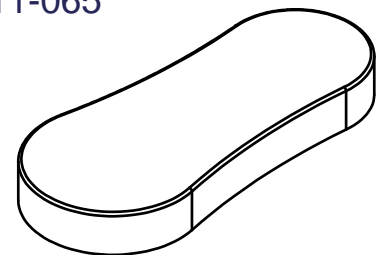

CSP-900 ASSEMBLY INSTRUCTIONS

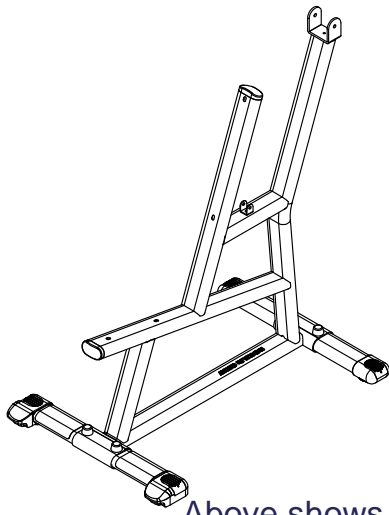

Above shows STEP1
assembled and completed

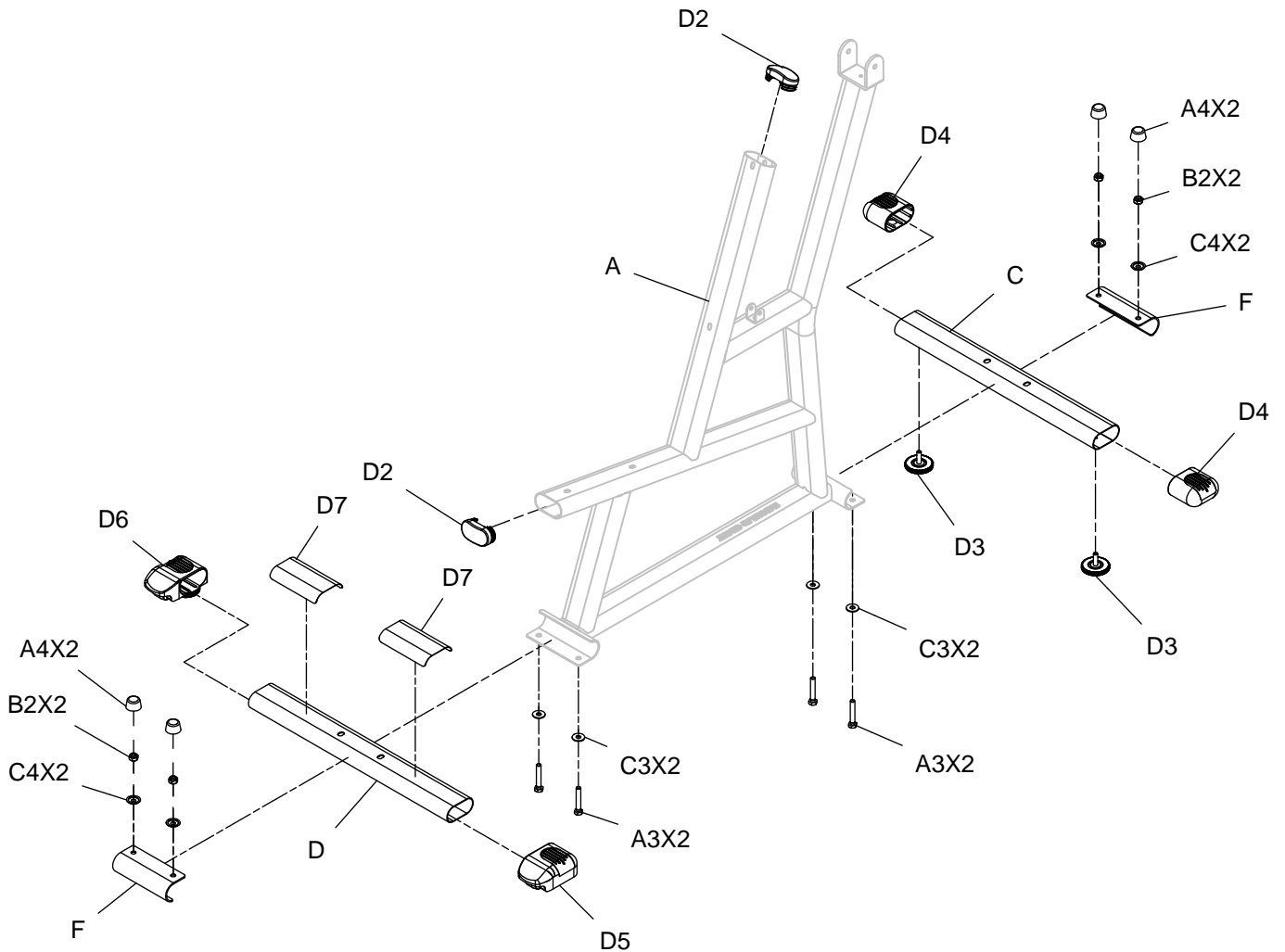

CSP-900 ASSEMBLY INSTRUCTIONS

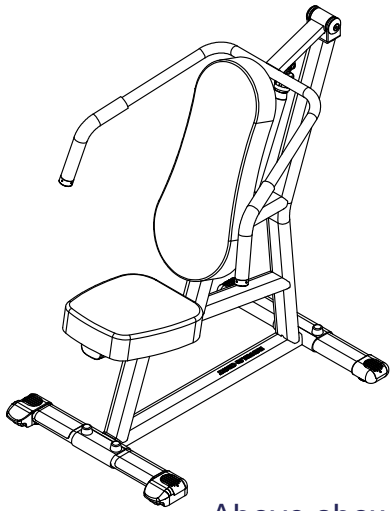

Above shows STEP2 assembled and completed

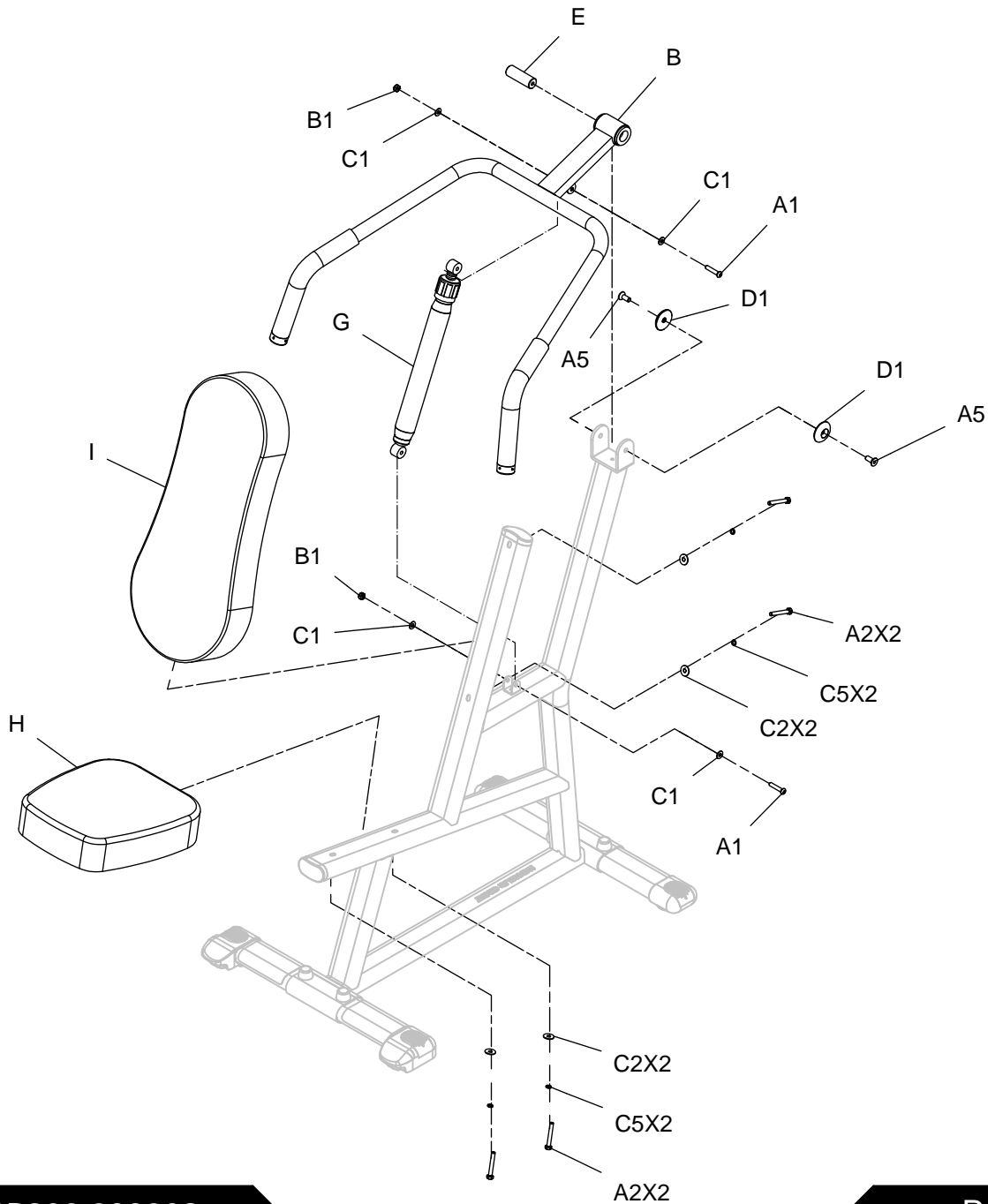

Cylinder Description and Assembly Instruction

※This model of cylinder contains a spring inside so it can not be pulled out by hand directly.

Part No.8830-016

Adapt Model: CLP-600

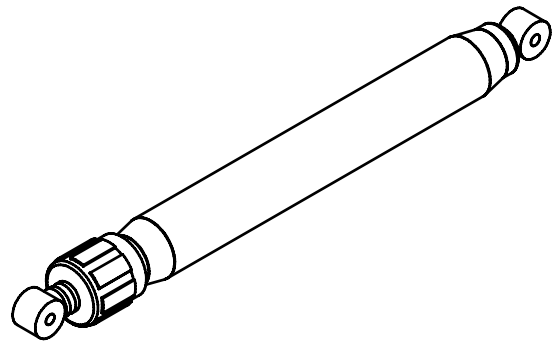
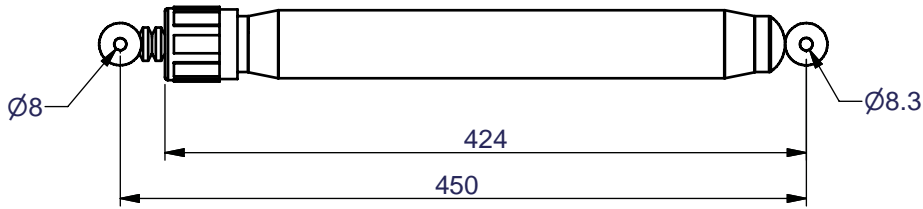

※This cylinder does not contain a spring, and it can be pulled out directly by hand.

Part No. 8830-017

Adapt Model: CBP300 · CLE500 · CAC700 · CSP900 · CAB1000

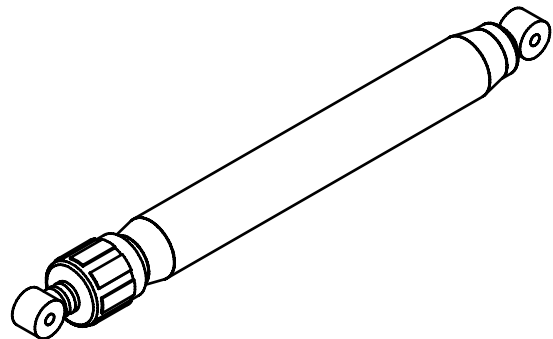
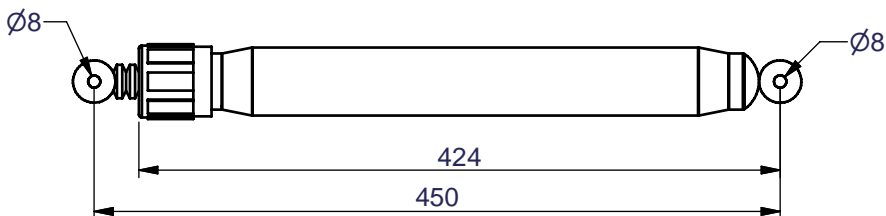

Cylinder Description and Assembly Instruction

- ※This cylinder does not contain a spring, and it can be pulled out directly by hand.
- ※No attached iron bush $\text{OD}\phi 16\text{X ID}\phi 8\text{X}22.5\text{L}$
- Part No. 8830-020
- Adapt Model: CEO-200, CPD-800

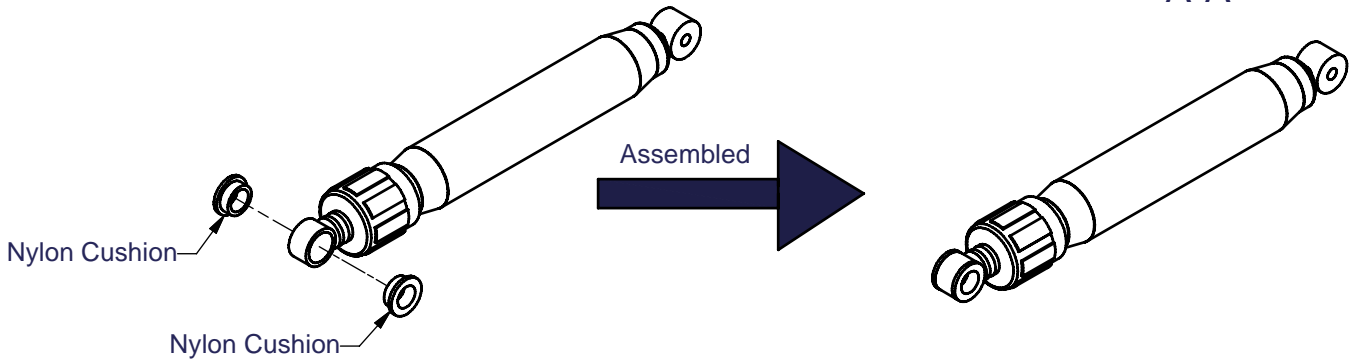
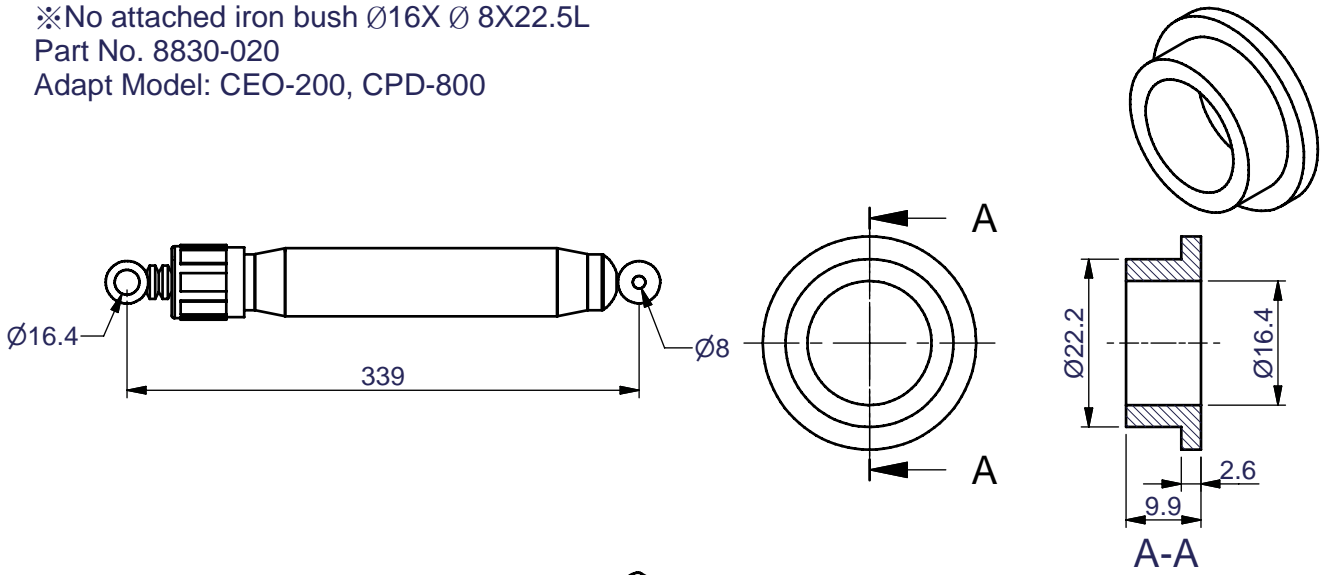

- ※This cylinder does not contain a spring, and it can be pulled out directly by hand.
- ※With attached iron bush $\text{OD}\phi 16\text{X ID}\phi 8\text{X}22.5\text{L}$
- Part No. 8830-020
- Adapt Model: CBC-400, CTH-1100

